

- Tube Fitting (Double Ferrule)-  
 Tube To Male Pipe Thread

# Male Connector

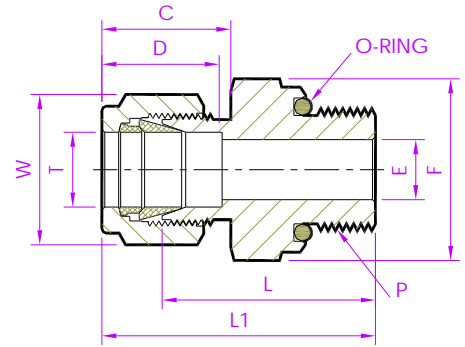

Fractional Tube x O-seal ISO Parallel (M)

Tubefit Part No.	Equivalent Part No. Type 1	Equivalent Part No. Type 2	TUBE OD Ø T	ISO Male Pipe Size P	ØE	D	C	L	L1	Body Hex F	Nut Hex W
<b>Dimensions in Inches</b>											
4 - MCD - 4OIP	-----	4MSC4R - ED	1/4	1/4	0.19	0.60	0.70	1.19	1.48	3/4	9/16
4 - MCD - 8OIP	-----	4MSC8R - ED		1/2	0.19			1.47	1.76	1.1/16	
6 - MCD - 6OIP	-----	6MSC6R - ED	3/8	3/8	0.28	0.66	0.76	1.31	1.60	7/8	11/16
8 - MCD - 4OIP	-----	8MSC4R - ED	1/2	1/4	0.25	0.90	0.86	1.29	1.69	13/16	7/8
8 - MCD - 6OIP	-----	8MSC6R - ED		3/8	0.31			1.29	1.69	7/8	
8 - MCD - 8OIP	-----	8MSC8R - ED		1/2	0.41			1.45	1.85	1.1/16	
12 - MCD - 12OIP	-----	12MSC12R - ED	3/4	3/4	0.63	0.96	0.86	1.58	1.98	1.5/16	1.1/8

NOTE : 1)The E Dimension is the minimum opening & Fittings of this group may be back drilling to lager ID at pipe thread or straight thread end.  
 2)Dimension L1, C, D is shown in the finger-tight position. 3)Dimensions are for reference only and are subject to change 4)ISO (BSP Parallel) thread as per BS 2779.

**- ALL PART NUMBERS ARE PROPRIETARY OF THEIR RESPECTIVE OWNERS. -**